

## Visión general

### Información del Producto

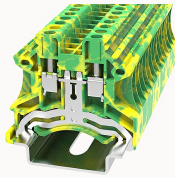

## DC2.5-PE-11020000028

Screw type Din-Rail TB, connector method: Screw/plug-in connector, Number of connectors: 2, Number of potentials: 1, Cross section: 0.2 mm<sup>2</sup> - 4 mm<sup>2</sup>, AWG: 28 - 12, Width: 5.1 mm, Color: green-yellow, Mounting type: NS 35/7.5, NS 35/15

### Ventajas del producto

- Steel screw connection technology, reliable connection;
- Grounding structure, protection circuit;
- The box has a baffle to prevent mis-insertion;
- Can be matched with marker strips to avoid incorrect insertion of wires.

### Certificación del producto



## Datos técnicos

### Dibujo del producto

### Modelo 3D

□

### Overview

Connection method	screw connection
Number of rows	1
number of connections	2
Open-end side panels	Yes
Insulation Materials	PA
Flame retardant grade, in line with UL 94	V0

### Dimension

NS 35/7,5 Height	41.5mm
End plate width	1.5mm
NS 35/15 Height	49mm
length	44.5mm
width	5.1mm
Height	40mm

#### Wiring data

Screw type	Slotted screw
Conductor cross section flexible (ferrule with plastic sleeve)	0.5-1.5mm <sup>2</sup>
Strip length	8~9mm
Conductor cross section solid	0.2~4mm <sup>2</sup>
Conductor cross section flexible	0.2~2.5mm <sup>2</sup>
Conductor cross section solid AWG	28~12
screw thread	M2.5
Tightening torque	0.4N.m

#### Environmental conditions

Ambient temperature (operation)	-40 °C ~ 105 °C (depending on derating curve)
Relative humidity (storage/transport)	25%~75%

#### IEC Electrical parameters

Rated surge voltage	8KV
---------------------	-----

#### Environmental protection

REACH SVHC	Lead 7439-92-1
RoHS	No excessive harmful substances

**Marker**

Top marker	/
Side marker	ZB5 / WB5
Marker support	/

**Accessories**

Slotted screwdriver size (Blade thickness x Width)	0.6x3.5
Bridge	/
End cover	D-DC2.5
Partition plate	/

**Installation**

End clamp	E-WS N / E-PC-1100A
Terminal strip marker support	KLM3-20x8 / KLM3-44x8 / DLM2 / DBE-1 / DBE-2
DIN rail	NS35/7.5 & NS35/15

**Marking & Installation**

Marking strip	ZB5
Marker cards	DBE-1

**Accessories**

End cover	D-DC2.5
End clamp	E-WS
DIN rail	NS35/7.5-1000-00A(H)

**Datos empresariales**

Número de pedido	11020000028
Unidad de embalaje	100
Cantidad mínima de pedido	100

Peso del producto (sin  
embalaje)

6.61

未注公差/General tolerances(mm)													0.1/10	
0	>3	>6	>10	>18	>30	>50	>80	>120	>180	>250	>315	>400		
~3	~6	~10	~18	~30	~50	~80	~120	~180	~250	~315	~400	~500	>500	
±0.12	±0.18	±0.22	±0.26	±0.31	±0.37	±0.57	±0.80	±0.93	±1.05	±1.15	±1.60	±2.20	±2.50	±2'

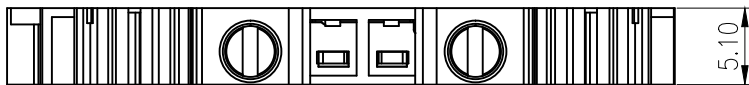

5.10

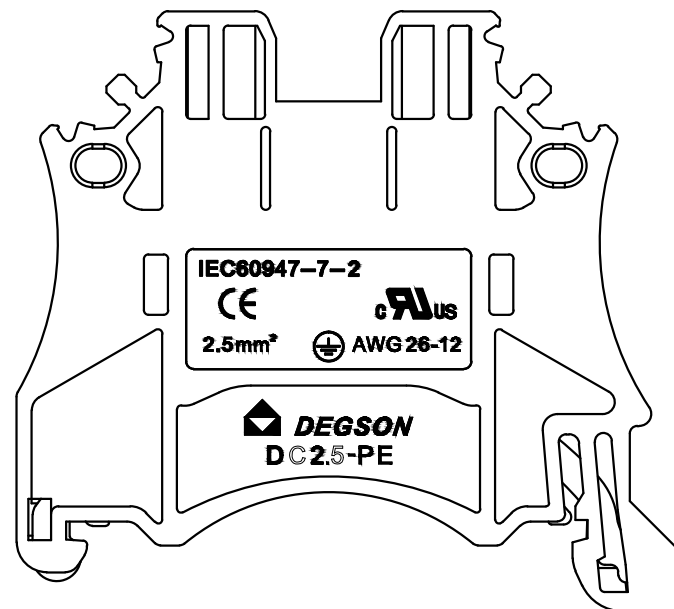
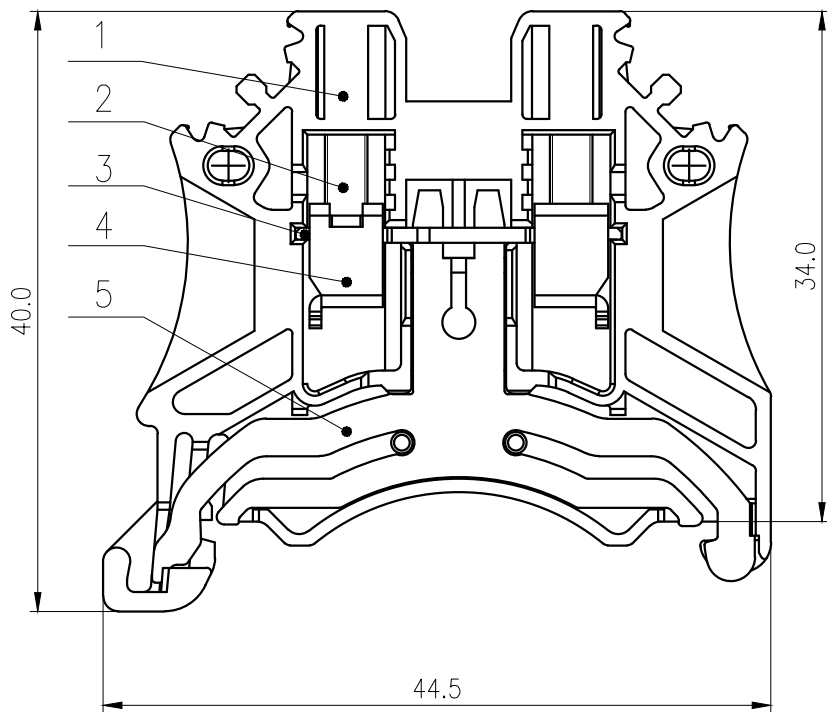

IEC 标准/IEC Standard:	
螺丝扭矩/Torque Tightening(N·m/Lb.in)	M2.5, 0.4/3.54
线径范围(硬线和软线)/Wire Range(rigid and flexible)(mm²/AWG)	0.2~2.5/26~12
间距/Pitch(mm)	5.10
剥线长度/Stripping length(mm)	8-9
使用温度范围/Operating temperature(°C)	-40~+105
符合RoHS环保要求/Conform to RoHS	Yes

5	Grounding	Copper alloy	Sn Plated
4	Cage	Steel	Zn Plated
3	Current Carrier	Copper	Sn Plated
2	Screw	Steel	Zn Plated
1	Housing	PA66	UL94 V-0
ITEM	NAME OF PART	MATERIAL	NOTES

REV	ECN	DESCRIPTION	DRFT	DATE

MATERIAL: /	SURFACE: /		
MAT NO.: /	宁波高松电子有限公司 NINGBO DEGSON ELECTRICAL CO., LTD		
STATUS: /			
APPD: Li GL 2020.05.27	NAME: DC2.5-PE-01P-1C-00A(H)		
CHKD: Mao J 2020.05.27	DRAWING NO.: DC2.5-PE-C01		
DRFT: XMY 2016.01.29	SCALE: 2:1		REV TO-2
⊕	SIZE: A4	TYPE: CUSTOMER DRAWING	SHEET 1/1